

ASK OPEN TYPE 2.4/3.0/3.2



ASK2.4-3.2F01HE

For installation information please refer to the tooling overview and manuals on our website www.scell-it.com
 Pour les conditions de pose, merci de vous référer à la description de l'outil et aux manuels disponibles sur notre site web.
 Angaben zur Verarbeitung entnehmen Sie bitte der Geräteübersicht und den Betriebsanleitungen auf unserer Website.
 Pro informace ohledně montáže navštivte naše webové stránky nebo nahlédněte do manuálu k nářadí.

ENGLISH	FRANÇAIS	DEUTSCH	CZECH
Mandrel : Steel	Tige : Acier	Dorn : Stahl	trn : Ocel
Body : Aluminium	Corps : Aluminium	Körper : Aluminium	ďřík : Hliník
Countersunk head	Tête fraisée à 120°	Senkkopf	zapuštěná hlava

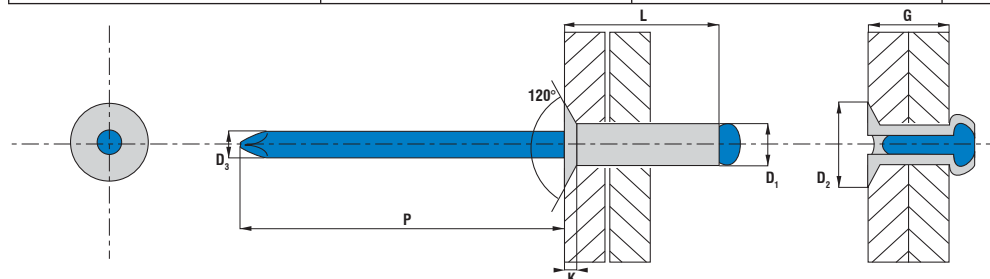

PART NO/REF	D ₁	L	D ₂	K	D ₃	P	G
	Ø (mm)	(mm)+1.0 / -0.2	Ø (mm)	(mm)	Ø (mm)	mini (mm)	min-max (mm)
ASK2406	2.4 +0.08 / -0.10	6.0	4.5 -0.4 / +0.0	0.60 -0.2 / +0.2	1.40	25	1.5-4.0
ASK2408		8.0					4.0-6.0
ASK2410		10.0					6.0-8.0
ASK3006	3.0 +0.08 / -0.10	6.0	6.0 -0.4 / +0.0	0.90 -0.2 / +0.2	1.78	27	1.5-3.5
ASK3008		8.0					3.5-5.5
ASK3010		10.0					5.5-7.0
ASK3012		12.0					7.0-9.0
ASK3206	3.2 +0.08 / -0.10	6.0	6.0 -0.4 / +0.0	0.90 -0.2 / +0.2	1.78	27	1.5-3.5
ASK3208		8.0					3.5-5.0
ASK3210		10.0					5.0-7.0
ASK3212		12.0					7.0-9.0
ASK3214		14.0					9.0-10.5
ASK3216		16.0					10.5-13.0

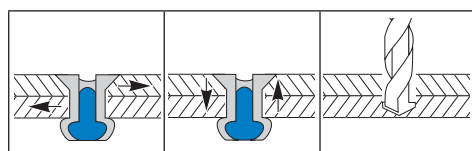

D ₁ (mm)	(N)	(N)	Ø (mm)
2.4	314	353	2.5
3.0	620	810	3.1
3.2	760	980	3.3

UNIT PLANT CERTIFICATES



ISO 9001:2000
TS 16949

Scell-it®
Engineering & Development

© 2009 Blue future Intellectual Properties

Data shown are subject to change without prior notice as a result of continuous product development and improvement policy.
Your local Scell-it representative is at your disposal should you need to confirm latest information.

ASK OPEN TYPE 4.0/4.8



ASK4.0-4.8FICHE

For installation information please refer to the tooling overview and manuals on our website www.scell-it.com
 Pour les conditions de pose, merci de vous référer à la description de l'outil et aux manuels disponibles sur notre site web.
 Angaben zur Verarbeitung entnehmen Sie bitte der Geräteübersicht und den Betriebsanleitungen auf unserer Website.
 Pro informace ohledně montáže navštivte naše webové stránky nebo nahlédněte do manuálu k nářadí.

ENGLISH	FRANÇAIS	DEUTSCH	CZECH
Mandrel : Steel	Tige : Acier	Dorn : Stahl	trn : Ocel
Body : Aluminium	Corps : Aluminium	Körper : Aluminium	ďřík : Hliník
Countersunk head	Tête fraisée à 120°	Senkkopf	zapuštěná hlava

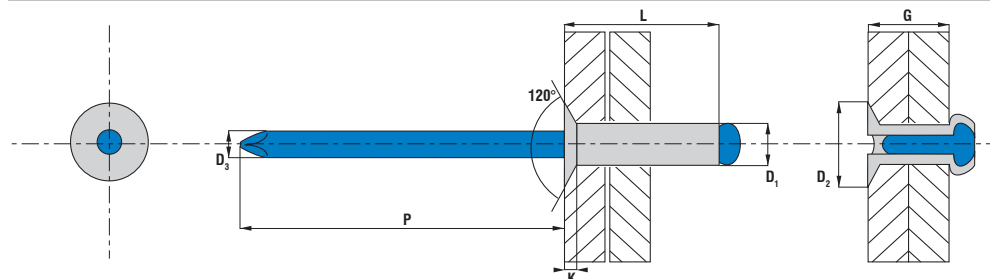

PART NO/REF	D ₁	L	D ₂	K	D ₃	P	G
	Ø (mm)	(mm)+1.0 / -0.2	Ø (mm)	(mm)	Ø (mm)	mini (mm)	min-max (mm)
ASK4006	4.0 +0.08 / -0.15	6.0	7.5 -0.5 / +0.0	1.00 -0.2 / +0.2	2.10	27	1.5-3.0
ASK4008		8.0					3.0-5.0
ASK4010		10.0					5.0-6.5
ASK4012		12.0					6.5-8.5
ASK4016		16.0					10.5-12.5
ASK4018		18.0					12.5-14.5
ASK4020		20.0					14.5-16.5
ASK4808	4.8 +0.08 / -0.15	8.0	9.0 -0.5 / +0.0	1.20 -0.2 / +0.2	2.70	27	2.0-4.5
ASK4810		10.0					4.5-6.0
ASK4812		12.0					6.0-8.0
ASK4814		14.0					8.0-10.0
ASK4816		16.0					10.0-12.0
ASK4818		18.0					12.0-14.0
ASK4820		20.0					14.0-16.0
ASK4825		25.0					16.0-21.0
ASK4830		30.0					21.0-25.0
ASK4835		35.0					25.0-30.0

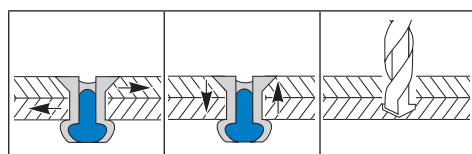

D ₁ (mm)	(N)	(N)	Ø (mm)
4.0	1 080	1 580	4.1
4.8	1 580	2 230	4.9

UNIT PLANT CERTIFICATES



ISO 9001:2000
TS 16949

Scell-it®
Engineering & Development

© 2009 Blue future Intellectual Properties

Data shown are subject to change without prior notice as a result of continuous product development and improvement policy.
Your local Scell-it representative is at your disposal should you need to confirm latest information.