

ASX OPEN TYPE 3.2/4.0/4.8



ASX3.2-4.8FICHE

For installation information please refer to the tooling overview and manuals on our website www.scell-it.com
 Pour les conditions de pose, merci de vous référer à la description de l'outil et aux manuels disponibles sur notre site web.
 Angaben zur Verarbeitung entnehmen Sie bitte der Geräteübersicht und den Betriebsanleitungen auf unserer Website.
 Pro informace ohledně montáže navštivte naše webové stránky nebo nahlédněte do manuálu k nářadí.

ENGLISH	FRANÇAIS	DEUTSCH	CZECH
Mandrel : Steel	Tige : Acier	Dorn : Stahl	trn : Ocel
Body : Aluminium	Corps : Aluminium	Körper : Aluminium	ďřík : Hliník
extra large head	Tête extra large	extra grosser Flachrundkopf	extravelká hlava

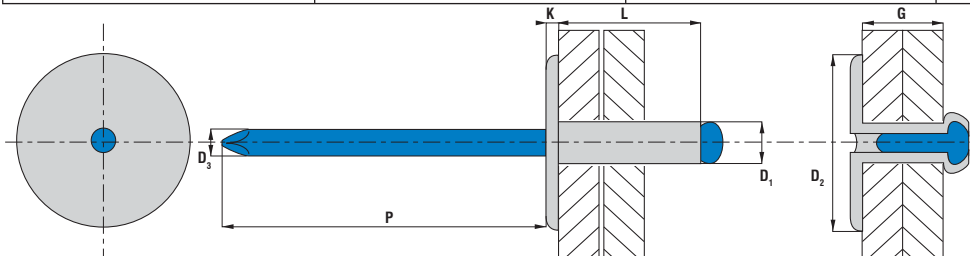

PART NO/REF	D ₁	L	D ₂	K	D ₃	P	G
	Ø (mm)	(mm)+1.0 / -0.2	Ø (mm)	(mm)	Ø (mm)	mini (mm)	min-max (mm)
ASX3206	3.2 +0.08 / -0.10	6.0	9.5 -0.5 / +0.0	2.0 -0.6 / +0.0	1.70	27	1.0-3.5
ASX3208		8.0					3.5-5.0
ASX3210		10.0					5.0-7.0
ASX3212		12.0					7.0-9.0
ASX3214		14.0					9.0-11.0
ASX4008	4.0 +0.08 / -0.15	8.0	12.0 -0.5 / +0.0	2.5 -0.8 / +0.0	2.10	27	3.0-5.0
ASX4010		10.0					5.0-6.5
ASX4012		12.0					6.5-8.5
ASX4014		14.0					8.5-10.5
ASX4016		16.0					10.5-12.5
ASX4018		18.0					12.5-15.0
ASX4020		20.0					15.0-16.5
ASX4810	4.8 +0.08 / -0.15	10.0	16.0 -0.5 / +0.0	2.5 -0.8 / +0.0	2.70	27	3.5-6.0
ASX4812		12.0					6.0-8.0
ASX4814		14.0					8.0-10.0
ASX4816		16.0					10.0-12.0
ASX4818		18.0					12.0-14.0
ASX4820		20.0					14.0-16.0
ASX4826		26.0					20.0-22.5
ASX4830		30.0					23.0-25.0
ASX4835		35.0					25.0-30.0

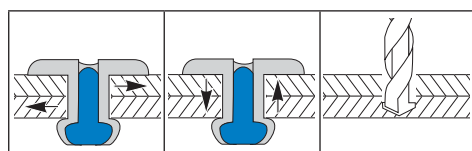

D ₁ (mm)	(N)	(N)	Ø (mm)
3.2	760	980	3.3
4.0	1 080	1 580	4.1
4.8	1 580	2 230	4.9

UNIT PLANT CERTIFICATES



ISO 9001:2000
TS 16949

Scell-it®
Engineering & Development

© 2009 Blue future Intellectual Properties

Data shown are subject to change without prior notice as a result of continuous product development and improvement policy.
Your local Scell-it representative is at your disposal should you need to confirm latest information.