

WAD CLOSED END 3.2/4.0/4.8/6.4



WAD3.2-6.4FCHE

For installation information please refer to the tooling overview and manuals on our website www.scell-it.com
 Pour les conditions de pose, merci de vous référer à la description de l'outil et aux manuels disponibles sur notre site web.
 Angaben zur Verarbeitung entnehmen Sie bitte der Geräteübersicht und den Betriebsanleitungen auf unserer Website.
 Pro informace ohledně montáže navštivte naše webové stránky nebo nahlédněte do manuálu k nářadí.

ENGLISH	FRANÇAIS	DEUTSCH	CZECH
Mandrel : Steel	Tige : Acier	Dorn : Stahl	trn : Ocel
Body : Aluminium	Corps : Aluminium	Körper : Aluminium	ďřík : Hliník
Dome head	Tête plate	Flachrundkopf	plochá hlava

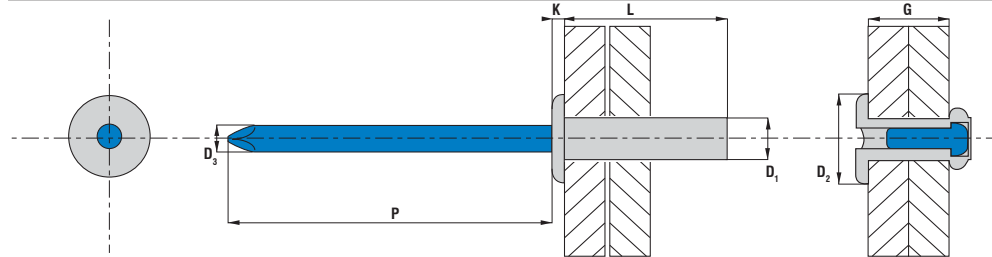

PART NO/REF	D ₁	L	D ₂	K	D ₃	P	G
	Ø (mm)	(mm)+1.0 / -0.2	Ø (mm)	(mm)	Ø (mm)	mini (mm)	min-max (mm)
WAD3206	3.2 +0.08 / -0.10	6.5	6.0 ±0.24	1.40 -0.3 / +0.0	1.70	27	0.5-2.0
WAD3208		8.0					2.0-3.5
WAD3210		9.5					3.5-5.0
WAD3212		12.7					6.5-8.0
WAD4008	4.0 +0.08 / -0.15	8.0	8.0 ±0.29	1.70 -0.4 / +0.0	2.18	27	0.5-3.5
WAD4010		9.5					3.5-4.5
WAD4012		12.7					6.5-8.0
WAD4015		15.0					8.0-10.5
WAD4808	4.8 +0.08 / -0.15	8.0	9.5 ±0.29	2.00 -0.5 / +0.0	2.63	27	1.0-3.0
WAD4810		9.5					3.0-4.5
WAD4812		12.5					6.0-7.5
WAD4814		14.0					7.5-9.0
WAD4816		16.0					9.0-11.0
WAD4818		18.0					11.0-13.0
WAD4821		21.0					13.0-16.0
WAD4825		25.0					16.0-20.0
WAD6412	6.4 +0.08 / -0.15	12.5	12.7 ±0.29	±			1.5-6.0
WAD6416		16.0					6.0-8.0

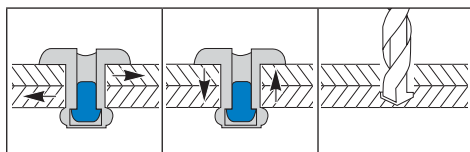

D ₁ (mm)	(N)	(N)	Ø (mm)
3.2	1 070	1 250	3.3
4.0	1 700	2 240	4.1
4.8	2 230	3 070	4.9
6.4	3 950	5 000	6.5

UNIT PLANT CERTIFICATES



ISO 9001:2000
TS 16949

Scell-it®
Engineering & Development

© 2009 Blue future Intellectual Properties

Data shown are subject to change without prior notice as a result of continuous product development and improvement policy.
Your local Scell-it representative is at your disposal should you need to confirm latest information.