

# SPECTRE™



## DESCRIPTION

- Spectre by Forgefix incorporates a long list of advanced screw features, often only found in premium screws
- Reamer to prevent jacking
- Serrated cutting thread improves pull out and reduces torque for a faster firmer fix
- Quick start type 17 slash point
- Double countersunk
- Universally accepted Pozi® compatible head
- Anti corrosion coating
- Fully threaded up to 50mm
- 40° deep single thread
- Surface hardened
- Synthetic lubrication

## APPLICATIONS

- Suitable for interior use, ideal for fixing into most wood applications

## CE APPROVED



- Tested to European inspection and certification standards EN 14592:2008+A1:2012

• **Material:**  
C1022

• **Surface Hardness:**  
550-800 HV 0.30

• **Case Depth:**  
0.1mm

## PRODUCT OVERVIEW

Code	Diameter (mm)	Length (mm)	Head	Recess	Finish	Box Qty	Bulk Box Qty
SPE312Y	3.0	12	Countersunk	Pozi®	Zinc Yellow Passivated	200	•
SPE316Y	3.0	16	Countersunk	Pozi®	Zinc Yellow Passivated	200	•
SPE320Y	3.0	20	Countersunk	Pozi®	Zinc Yellow Passivated	200	•
SPE325Y	3.0	25	Countersunk	Pozi®	Zinc Yellow Passivated	200	•
SPE330Y	3.0	30	Countersunk	Pozi®	Zinc Yellow Passivated	200	•
SPE3516Y	3.5	16	Countersunk	Pozi®	Zinc Yellow Passivated	200	•
SPE3520Y	3.5	20	Countersunk	Pozi®	Zinc Yellow Passivated	200	•
SPE3525Y	3.5	25	Countersunk	Pozi®	Zinc Yellow Passivated	200	•
SPE3530Y	3.5	30	Countersunk	Pozi®	Zinc Yellow Passivated	200	•
SPE3540Y	3.5	40	Countersunk	Pozi®	Zinc Yellow Passivated	200	•
SPE3550Y	3.5	50	Countersunk	Pozi®	Zinc Yellow Passivated	200	•
SPE416Y	4.0	16	Countersunk	Pozi®	Zinc Yellow Passivated	200	•
SPE420Y	4.0	20	Countersunk	Pozi®	Zinc Yellow Passivated	200	•
SPE425Y(B)	4.0	25	Countersunk	Pozi®	Zinc Yellow Passivated	200	1000
SPE430Y(B)	4.0	30	Countersunk	Pozi®	Zinc Yellow Passivated	200	1000
SPE435Y	4.0	35	Countersunk	Pozi®	Zinc Yellow Passivated	200	•
SPE440Y(B)	4.0	40	Countersunk	Pozi®	Zinc Yellow Passivated	200	1000
SPE445Y	4.0	45	Countersunk	Pozi®	Zinc Yellow Passivated	200	•
SPE450Y(B)	4.0	50	Countersunk	Pozi®	Zinc Yellow Passivated	200	500
SPE460Y(B)	4.0	60	Countersunk	Pozi®	Zinc Yellow Passivated	200	500
SPE470Y(B)	4.0	70	Countersunk	Pozi®	Zinc Yellow Passivated	200	500
SPE4530Y	4.5	30	Countersunk	Pozi®	Zinc Yellow Passivated	200	•
SPE4540Y	4.5	40	Countersunk	Pozi®	Zinc Yellow Passivated	200	•
SPE4550Y	4.5	50	Countersunk	Pozi®	Zinc Yellow Passivated	200	•
SPE4560Y	4.5	60	Countersunk	Pozi®	Zinc Yellow Passivated	100	•
SPE4570Y	4.5	70	Countersunk	Pozi®	Zinc Yellow Passivated	100	•
SPE4580Y	4.5	80	Countersunk	Pozi®	Zinc Yellow Passivated	100	•
SPE525Y	5.0	25	Countersunk	Pozi®	Zinc Yellow Passivated	200	•
SPE530Y(B)	5.0	30	Countersunk	Pozi®	Zinc Yellow Passivated	200	1000
SPE540Y(B)	5.0	40	Countersunk	Pozi®	Zinc Yellow Passivated	200	500
SPE550Y(B)	5.0	50	Countersunk	Pozi®	Zinc Yellow Passivated	200	500
SPE560Y(B)	5.0	60	Countersunk	Pozi®	Zinc Yellow Passivated	100	500
SPE570Y(B)	5.0	70	Countersunk	Pozi®	Zinc Yellow Passivated	100	300
SPE580Y(B)	5.0	80	Countersunk	Pozi®	Zinc Yellow Passivated	100	300
SPE590Y(B)	5.0	90	Countersunk	Pozi®	Zinc Yellow Passivated	100	300
SPE5100Y(B)	5.0	100	Countersunk	Pozi®	Zinc Yellow Passivated	100	300
SPE5120Y	5.0	120	Countersunk	Pozi®	Zinc Yellow Passivated	100	•
SPE640Y	6.0	40	Countersunk	Pozi®	Zinc Yellow Passivated	200	•
SPE650Y	6.0	50	Countersunk	Pozi®	Zinc Yellow Passivated	100	•
SPE660Y	6.0	60	Countersunk	Pozi®	Zinc Yellow Passivated	100	•
SPE670Y	6.0	70	Countersunk	Pozi®	Zinc Yellow Passivated	100	•
SPE680Y	6.0	80	Countersunk	Pozi®	Zinc Yellow Passivated	100	•
SPE690Y	6.0	90	Countersunk	Pozi®	Zinc Yellow Passivated	100	•
SPE6100Y	6.0	100	Countersunk	Pozi®	Zinc Yellow Passivated	100	•
SPE6120Y	6.0	120	Countersunk	Pozi®	Zinc Yellow Passivated	100	•
SPE6130Y	6.0	130	Countersunk	Pozi®	Zinc Yellow Passivated	100	•
SPE6150Y	6.0	150	Countersunk	Pozi®	Zinc Yellow Passivated	100	•
SPE6180Y	6.0	180	Countersunk	Pozi®	Zinc Yellow Passivated	100	•
OPSPE900Y	Assorted		Countersunk	Pozi®	Zinc Yellow Passivated	100	•

(B) Bulk Box

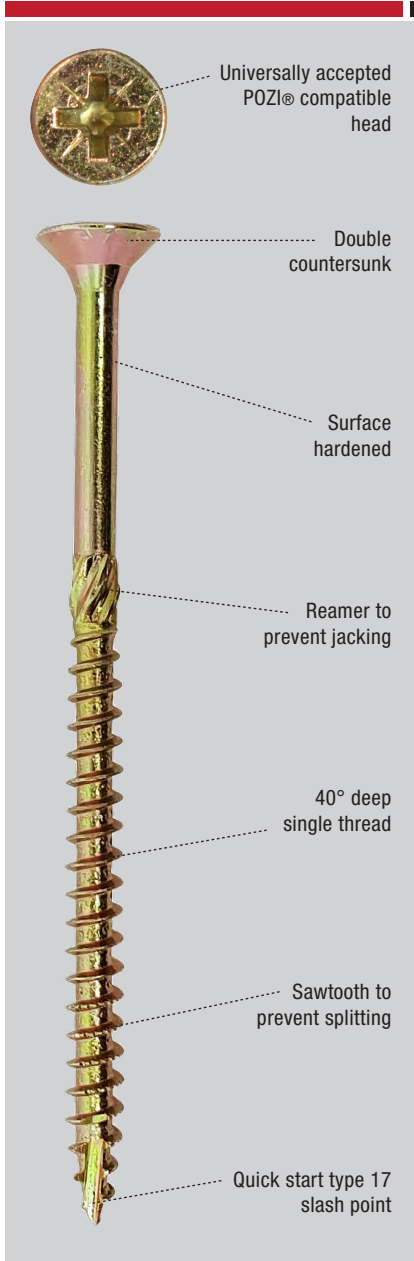

## TECHNICAL INFORMATION

Size (mm)	Imperial Size	Insert Bit Size	Thread Length	Breaking Torque Min.	Torsional Ratio	Tensile Strength
3.0 x 12	1/2" x 4	PZ1	Fully Threaded	15Kg-cm	2.20	389Nmm <sup>2</sup>
3.0 x 16	5/8" x 4	PZ1	Fully Threaded	15Kg-cm	2.20	389Nmm <sup>2</sup>
3.0 x 20	3/4" x 4	PZ1	Fully Threaded	15Kg-cm	2.20	389Nmm <sup>2</sup>
3.0 x 25	1" x 4	PZ1	Fully Threaded	15Kg-cm	2.20	389Nmm <sup>2</sup>
3.0 x 30	1 1/4" x 4	PZ1	Fully Threaded	15Kg-cm	2.20	389Nmm <sup>2</sup>
3.5 x 16	5/8" x 6	PZ2	Fully Threaded	20Kg-cm	2.96	363Nmm <sup>2</sup>
3.5 x 20	3/4" x 6	PZ2	Fully Threaded	20Kg-cm	2.96	363Nmm <sup>2</sup>
3.5 x 25	1" x 6	PZ2	Fully Threaded	20Kg-cm	2.96	363Nmm <sup>2</sup>
3.5 x 30	1 1/4" x 6	PZ2	Fully Threaded	20Kg-cm	2.96	363Nmm <sup>2</sup>
3.5 x 40	1 1/2" x 6	PZ2	Fully Threaded	20Kg-cm	2.96	363Nmm <sup>2</sup>
3.5 x 50	2" x 6	PZ2	Fully Threaded	20Kg-cm	2.96	363Nmm <sup>2</sup>
4.0 x 16	5/8" x 8	PZ2	Fully Threaded	30Kg-cm	2.87	363Nmm <sup>2</sup>
4.0 x 20	3/4" x 8	PZ2	Fully Threaded	30Kg-cm	2.87	363Nmm <sup>2</sup>
4.0 x 25	1" x 8	PZ2	Fully Threaded	30Kg-cm	2.87	363Nmm <sup>2</sup>
4.0 x 30	1 1/4" x 8	PZ2	Fully Threaded	30Kg-cm	2.87	363Nmm <sup>2</sup>
4.0 x 35	1 3/8" x 8	PZ2	Fully Threaded	30Kg-cm	2.87	363Nmm <sup>2</sup>
4.0 x 40	1 1/2" x 8	PZ2	Fully Threaded	30Kg-cm	2.87	363Nmm <sup>2</sup>
4.0 x 45	1 3/4" x 8	PZ2	Fully Threaded	30Kg-cm	2.87	363Nmm <sup>2</sup>
4.0 x 50	2" x 8	PZ2	30mm	30Kg-cm	2.87	363Nmm <sup>2</sup>
4.0 x 60	2 3/8" x 8	PZ2	36mm	30Kg-cm	2.87	363Nmm <sup>2</sup>
4.0 x 70	2 3/4" x 8	PZ2	42mm	30Kg-cm	2.87	363Nmm <sup>2</sup>
4.5 x 30	1 1/4" x 9	PZ2	Fully Threaded	43Kg-cm	2.69	380Nmm <sup>2</sup>
4.5 x 40	1 1/2" x 9	PZ2	Fully Threaded	43Kg-cm	2.69	380Nmm <sup>2</sup>
4.5 x 50	2" x 9	PZ2	30mm	43Kg-cm	2.69	380Nmm <sup>2</sup>
4.5 x 60	2 3/8" x 9	PZ2	36mm	43Kg-cm	2.69	380Nmm <sup>2</sup>
4.5 x 70	2 3/4" x 9	PZ2	42mm	43Kg-cm	2.69	380Nmm <sup>2</sup>
4.5 x 80	3 1/4" x 9	PZ2	48mm	43Kg-cm	2.69	380Nmm <sup>2</sup>
5.0 x 25	1" x 10	PZ2	Fully Threaded	62Kg-cm	3.12	350Nmm <sup>2</sup>
5.0 x 30	1 1/4" x 10	PZ2	Fully Threaded	62Kg-cm	3.12	350Nmm <sup>2</sup>
5.0 x 40	1 1/2" x 10	PZ2	Fully Threaded	62Kg-cm	3.12	350Nmm <sup>2</sup>
5.0 x 50	2" x 10	PZ2	30mm	62Kg-cm	3.12	350Nmm <sup>2</sup>
5.0 x 60	2 3/8" x 10	PZ2	36mm	62Kg-cm	3.12	350Nmm <sup>2</sup>
5.0 x 70	2 3/4" x 10	PZ2	42mm	62Kg-cm	3.12	350Nmm <sup>2</sup>
5.0 x 80	3 1/4" x 10	PZ2	48mm	62Kg-cm	3.12	350Nmm <sup>2</sup>
5.0 x 90	3 1/2" x 10	PZ2	54mm	62Kg-cm	3.12	350Nmm <sup>2</sup>
5.0 x 100	4" x 10	PZ2	60mm	62Kg-cm	3.12	350Nmm <sup>2</sup>
5.0 x 120	4 3/4" x 10	PZ2	72mm	62Kg-cm	3.12	350Nmm <sup>2</sup>
6.0 x 40	1 1/2" x 12	PZ3	Fully Threaded	108Kg-cm	3.00	388Nmm <sup>2</sup>
6.0 x 50	2" x 12	PZ3	30mm	108Kg-cm	3.00	388Nmm <sup>2</sup>
6.0 x 60	2 3/8" x 12	PZ3	36mm	108Kg-cm	3.00	388Nmm <sup>2</sup>
6.0 x 70	2 3/4" x 12	PZ3	42mm	108Kg-cm	3.00	388Nmm <sup>2</sup>
6.0 x 80	3 1/2" x 12	PZ3	48mm	108Kg-cm	3.00	388Nmm <sup>2</sup>
6.0 x 90	3 1/2" x 12	PZ3	54mm	108Kg-cm	3.00	388Nmm <sup>2</sup>
6.0 x 100	4" x 12	PZ3	60mm	108Kg-cm	3.00	388Nmm <sup>2</sup>
6.0 x 120	4 3/4" x 12	PZ3	72mm	108Kg-cm	3.00	388Nmm <sup>2</sup>
6.0 x 130	5 1/4" x 12	PZ3	75mm	108Kg-cm	3.00	388Nmm <sup>2</sup>
6.0 x 150	6" x 12	PZ3	75mm	108Kg-cm	3.00	388Nmm <sup>2</sup>
6.0 x 180	7" x 12	PZ3	75mm	108Kg-cm	3.00	388Nmm <sup>2</sup>

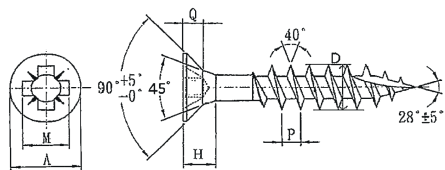

		A	M	Q	H	D	P
<b>M3.0</b>	MIN.	5.70	3.00	1.60	3.20	2.75	1.35
	MAX.	6.05	3.00	2.11	3.20	3.05	1.35
<b>M3.5</b>	MIN.	6.64	4.00	1.76	3.60	3.20	1.60
	MAX.	7.05	4.00	2.16	3.60	3.55	1.60

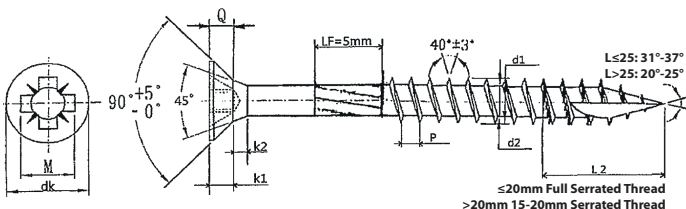

		dk	M	Q	k1	k2	d1	d2	P
<b>M4.0</b>	MIN.	7.50	4.4	2.05	1.91	1.66	3.70	2.25	1.8
	MAX.	8.05	4.4	2.50	1.91	1.66	4.05	2.50	1.8
<b>M4.5</b>	MIN.	8.50	4.8	2.60	2.16	1.73	4.20	2.45	2.0
	MAX.	9.05	4.8	3.10	2.16	1.73	4.55	2.70	2.0

		dk	M	Q	k1	k2	d1	d2	P
<b>M5.0</b>	MIN.	9.50	5.3	2.99	2.40	2.03	4.70	2.80	2.2
	MAX.	10.05	5.3	3.45	2.40	2.03	5.05	3.00	2.2
<b>M6.0</b>	MIN.	11.40	6.6	2.99	2.90	2.39	5.70	3.55	2.6
	MAX.	12.10	6.6	3.45	2.90	2.39	6.05	3.70	2.6